

COST VALUE 2020

www.costvsvalue.com

remodeling
YOUR TOOLBOX FOR SUCCESS

Project Descriptions

BATHROOM ADDITION—MIDRANGE

Add 6x8-foot bathroom over crawlspace with poured concrete walls. Use cultured-stone vanity top with molded sink; standard chrome faucets; 30x60-inch white fiberglass tub/shower with ceramic tile surround; single-lever temperature and pressure-balanced faucet; white low-profile toilet; general and spot lighting; electrical wiring to code; mirrored medicine cabinet; linen storage closet or cabinet; painted trim; ceramic tile floor.

BATHROOM ADDITION—UPSCALE

Add new 100-square-foot master bath to existing master bedroom over crawlspace. Include 42x42-inch neo-angle shower with ceramic tile walls, accent strip, recessed shower caddy, body-spray fixtures, and frameless glass enclosure. Put in freestanding soaker tub with high-end faucets; stone countertop with two sinks; two mirrored medicine cabinets with lighting; a compartmentalized commode area with one-piece toilet; and a humidistat-controlled exhaust fan. Use larger matching ceramic tiles on the floor, laid on diagonal with ceramic tile base molding. Add general and spot lighting and waterproof shower fixture. Cabinetry has custom drawer base, wall cabinets. Extend HVAC. Electric in-floor heating.

BATH REMODEL—MIDRANGE

Update existing 5x7-foot bathroom. Replace all fixtures to include 30x60-inch porcelain-on-steel tub with 4x4-inch ceramic tile surround; new single-lever temperature and pressure-balanced shower control; standard white toilet; solid-surface vanity counter with integral sink; recessed medicine cabinet with light; ceramic tile floor; vinyl wallpaper.

BATH REMODEL—UPSCALE

Expand existing 35-square-foot bathroom to 100 sf within existing house footprint. Relocate all fixtures. Include 42x42-inch neo-angle shower with ceramic tile walls with accent strip, recessed shower caddy, body-spray fixtures, and frameless glass enclosure. Include freestanding soaker tub with high-end faucets; stone countertop with two sinks; two mirrored medicine cabinets with lighting; a compartmentalized commode area with one-piece toilet; and a humidistat-controlled exhaust fan. Use all color fixtures. Use larger matching ceramic tiles on the floor, laid on diagonal with ceramic tile base molding. Add general and spot lighting including waterproof shower fixture. Cabinetry has custom drawer base, wall cabinets. Extend HVAC. Electric in-floor heating.

UNIVERSAL DESIGN BATH REMODEL

Update existing 5x7-foot space to be wheelchair-accessible (zero-threshold, 36-inch-wide door) and install flat-panel electrical switches at sitting level (36 to 42 inches above floor). Replace toilet with comfort height fixture featuring elongated bowl and bidet-type seat. Remove existing bathtub and install curbless, tiled, walk-in shower with adjustable showerhead, fold-out seat, thermostatic

mixing valve, and bi-directional glass door. Replace flooring with electric radiant heat beneath new luxury vinyl tile flooring. Install adaptive living vanity with easy-grasp handles and adjustable mirror. Install LED lights, infrared ceiling light, night light, and ultra-quiet vent fan with humidity-sensing controls. Install ceramic tiles on walls with two contrasting color stripes. Install nine towel bars that can support 250 pounds and reconfigure storage to be accessible from a seated position.

MINOR KITCHEN REMODEL—MIDRANGE

In functional but dated 200-square-foot kitchen with 30 linear feet of cabinetry and countertops, leave cabinet boxes in place but replace fronts with new shaker-style wood panels and drawer fronts, including new hardware. Replace cooktop/oven range and slide-in refrigerator with new energy-efficient models. Replace laminate countertops; install midpriced sink and faucet. Add new resilient flooring. Finish with painted walls, trim, and ceiling.

MAJOR KITCHEN REMODEL—MIDRANGE

Update outmoded 200-square-foot kitchen with functional layout of 30 linear feet of semi-custom wood cabinets, including 3x5-foot island; laminate countertops; and standard double-tub stainless-steel sink with standard single-lever faucet. Include energy-efficient range, vented range hood, built-in microwave, dishwasher, garbage disposal, and custom lighting. Add new resilient flooring. Finish with painted walls, trim, and ceiling.

MAJOR KITCHEN REMODEL—UPSCALE

Update outmoded 200-square-foot kitchen with 30 linear feet of top-of-the-line custom white cabinets with built-in sliding shelves and other interior accessories. Include stone countertops with imported ceramic- or glass-tile backsplash; built-in refrigerator, commercial-grade cooktop and vent hood, wall oven, and built-in microwave unit. Install high-end undermount sink with designer faucets and water filtration system. Add new general and task lighting, including low-voltage undercabinet lights. Install tile or similar flooring that looks like wood.

MASTER SUITE ADDITION—MIDRANGE

Add 24x16-foot master bedroom suite over crawlspace. Include walk-in closet/dressing area, freestanding soaker tub, separate 3x4-foot ceramic tile shower, and double-bowl vanity with solid-surface countertop. Carpet the bedroom floor; put tile in bath. Paint walls, ceiling, and trim. Install general and spot lighting, exhaust fan.

MASTER SUITE ADDITION—UPSCALE

Add 32x20-foot master bedroom suite over crawlspace. Add spacious sleeping area with lounging/sitting area adjacent to large master bath. Include custom bookcases and built-in storage with millwork details; high-end gas fireplace with stone hearth and custom mantle; and walk-in closet/dressing area with natural light, mirrors, and linen

COST VS VALUE 2020

storage. Add French doors. Bathroom includes walk-in shower with dual-shower system, stone walls and floor, and custom frameless glass enclosure. Add freestanding soaker tub. Include two sinks in separate custom vanities with stone countertops and large mirrors. Create partitioned area for luxury one-piece toilet. Outside the bath, add 5-foot-long hospitality center with bar sink, undercounter refrigerator, custom cabinetry, stone countertop, and microwave. Include soundproofing, in-floor heating, custom wall finishes and hardware, general and spot lighting, and high-end lighting controls.

DECK ADDITION—COMPOSITE

Add 16x20-foot deck using pressure-treated joists supported by 4x4-inch posts anchored to concrete piers. Install composite deck material in a simple linear pattern. Include built-in bench and planter of the same decking material. Include stairs, assuming three steps to grade. Provide a complete railing using a matching system made of the same composite as the decking material.

DECK ADDITION—WOOD

Add 16x20-foot deck using pressure-treated joists supported by 4x4-inch posts anchored to concrete piers. Install pressure-treated deck boards in a simple linear pattern. Include built-in bench and planter of the same decking material. Include stairs, assuming three steps to grade. Provide a complete railing system using pressure-treated wood posts, railings, and balusters.

ENTRY DOOR REPLACEMENT—STEEL

Remove existing 3-0/6-8 entry door and jambs and replace with new 20-gauge steel unit, including a clear, dual-pane half-glass panel, jambs, and aluminum threshold with composite stop. Door is factory finished with same color both sides. Exterior brick-mold and 2.5-inch interior colonial or ranch casings in poplar or equal prefinished to match door color. Replace existing lockset.

GRAND ENTRANCE—FIBERGLASS

Remove existing 3-0/6-8 entry door and cut and reframe opening for a 12-36-12 entrance door with dual sidelights. Move double-gang electrical box with two switches. Fiberglass door blank matches upscale entry, including color, threshold, lockset, and decorative half-glass; sidelights match door. PVC-wrapped exterior trim in color to match existing trim; wider interior colonial or ranch casings (3.5-inch to cover new jack studs) in hardwood stained to match door. All work to be completed in one day.

GARAGE DOOR REPLACEMENT

Remove and dispose of existing 16x7-foot garage door and tracks. Install new four-section garage door on new heavy-duty galvanized steel tracks; reuse existing motorized opener. New door has a lifetime warranty, and is made with high-tensile-strength steel with two coats of factory-applied paint, is foam insulated to minimum R-12, and includes thermal seals between pinch-resistant panels. Windows in top panel are ½-inch insulated glass. Hardware includes galvanized steel hinges and ball-bearing urethane rollers.

MANUFACTURED STONE VENEER

Remove 300-square-foot continuous band of existing vinyl siding from bottom third of street-facing façade. Replace with adhered manufactured stone veneer, including 36 linear feet (LF) of sills, 40 LF of corners, and one address block. Installation includes two separate layers of water-resistive barrier laid over bare sheathing, corrosion-resistant lath and fasteners, and nominal ½-inch-thick mortar scratch coat and setting bed. Outline entry archway; use an 8x10-inch keystone and a soldier course of flats on either side.

SIDING REPLACEMENT—FIBER CEMENT

Replace 1,250 square feet of existing siding with new fiber-cement siding, factory primed and factory painted, and installed to manufacturer's specifications. Include factory trim at all openings and corners.

SIDING REPLACEMENT—VINYL

Replace 1,250 square feet of existing siding with new vinyl siding installed to manufacturer's specifications. Include factory trim at all openings and corners.

WINDOW REPLACEMENT—VINYL

Replace 10 existing 3x5-foot double-hung windows with insulated, low-E, simulated-divided-light vinyl windows with a custom-color exterior finish. Trim exterior to match existing; do not disturb existing interior trim.

WINDOW REPLACEMENT—WOOD

Replace 10 existing 3x5-foot double-hung windows with insulated, low-E, simulated-divided-light wood windows. Interior finish of stained hardwood; exterior finish of custom-color aluminum cladding. Trim exterior to match existing; do not disturb existing interior trim.

ROOFING REPLACEMENT—ASPHALT SHINGLES

Remove and dispose of existing roofing to bare wood sheathing. Install 30 squares of min. 235-lb. fiberglass asphalt shingles (min. 25-year warranty) with new 30-lb. felt (or equivalent synthetic) underlayment, galvanized drip edge, and mill-finish aluminum flashing. Assume a rectangular hip roof; custom flashing at two average-size skylights; and custom cap treatment at vented ridge.

ROOFING REPLACEMENT—METAL

Remove and dispose of existing roofing to bare wood sheathing. Install ice-barrier membrane at roof perimeter, and premium-grade synthetic underlayment over roof. Install 3,000 square feet of prefinished, standing-seam metal roofing with matching pre-formed accessories, including drip edge, gable trim, and vented ridge flashing. Assume a rectangular hip roof; custom flashing at two average-size skylights; custom cap treatment at vented ridge.

Reuse and Licensing of Data

COPYRIGHTED MATERIAL

The Remodeling Cost vs. Value Report contains copyrighted material that is being made available in free downloadable PDF documents as a public service. Any reuse without express permission is prohibited, including but not limited to the following:

1. **RESALE.** The Cost vs. Value Report, whether in whole or part, may not be reproduced and sold in any format, including print, digital, electronic file, fax, or other medium.
2. **PUBLICATION OF DATA.** The Cost vs. Value Report, whether in whole or part, may not be distributed or published in any format, including print, digital, electronic file, fax, or other medium without obtaining express permission.
3. **APPLICATIONS/SOFTWARE.** The Cost vs. Value Report, whether in whole or part, may not be incorporated for use in any kind of computer- or Web-based application, calculator, database, or other automated, electronic, or digital device, instrument, or software except as licensed by Hanley Wood (see Licensing, below).

EXCERPTING COST VS. VALUE REPORT DATA

Excerpts of Cost vs. Value Report data may not take the form of a chart or table that simulates the manner in which the data is displayed at www.costvsvalue.com.

Excerpts of Cost vs. Value Report data may, however, be made as part of a narrative, provided that the sum total of all excerpts from any publisher in all formats does not exceed data from more than five projects.

ACKNOWLEDGING COST VS. VALUE AS DATA SOURCE

When excerpting Cost vs. Value Report data, refer to the “Remodeling 2020 Cost vs. Value Report” and include the URL www.costvsvalue.com, as in the following examples:

- “... according to the Remodeling 2020 Cost vs. Value Report (www.costvsvalue.com) ...”
- “... as compiled in the Remodeling 2020 Cost vs. Value Report (www.costvsvalue.com) ...”

This form of citation should be used in the first instance on every page of a multipage online story that cites the Cost vs. Value Report on multiple pages. Subsequent references on a given page may be foreshortened to “Cost vs. Value Report.”

All excerpts must be accompanied by one or more instances of the following acknowledgements of copyright:

“© 2020 Hanley Wood Media Inc. Complete data from the Remodeling 2020 Cost vs. Value Report can be downloaded free at www.costvsvalue.com.”

LICENSING OF 2020 COST VS. VALUE REPORT DATA

For permission to license data from the 2020 Cost vs. Value Report for use in any kind of computer- or Web-based application, calculator, database, or other automated, electronic, or digital device, instrument, or software, include the following in an email request to costvsvaluepermissions@hanleywood.com

- a description of the application, calculator, or device for which use of the data is being requested. Include the length of time for which the license is sought.
- a detailed description of the material to be licensed (e.g., specific projects, cities, etc.).

COST^{VS}VALUE²⁰²⁰

The 2020 REMODELING Cost vs. Value Report has been brought to you thanks to the following companies:



Do Decking Differently™

Discover the decking that is revolutionizing outdoor living spaces. Made from the most advanced material technology in both the cap and core, TimberTech AZEK Decking is the most resistant to the elements, stays cooler on sunny days, and offers up to 40% better slip resistance than competitors. With narrow, standard, and wide width boards available, designing a truly one-of-a-kind deck is easy.

Unrivaled Decking Technology

- **Save time on installation with 30% lighter boards and no pre-drilling.** TimberTech AZEK capped polymer boards permit countersinking with no surface distortion or cracking.
- **Durable, scratch- and dent-resistant** decking than many competitive composites and wood.
- Homeowners are confidently covered by our **Lifetime Limited Product Warranty and 50-Year Fade & Stain Warranty** that is unrivalled in the industry.



TimberTech.com



Engineered to strengthen your business, too.

When you use James Hardie® fiber cement products, expect more than industry-leading performance. Expect industry-leading support. Our Contractor Alliance™ Program means more qualified sales leads, dedicated, hands-on training and valuable marketing tools to grow your business. Put the program to work for you at HardieAlliance.com.



JamesHardie™

Made for What Matters



BUILD MORE. SELL MORE. WASTE LESS.

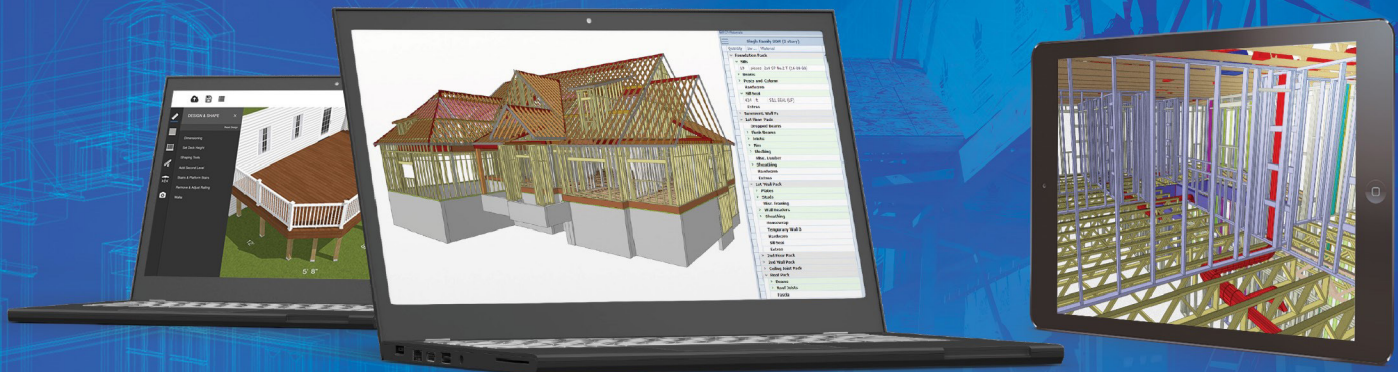

MiTek® is changing the way builders and contractors are thinking about building. Our software is shortening cycle times and eliminating waste for builds of all sizes, not to mention helping you sell more jobs. Build trust with a 3D BIM of the project, build your profits with reduced error and waste, and build your reputation with a faster completion time!

MiTek®

A REMODELING PROJECT *you can take* TO THE BANK



**A top
ranked
project
for return on
investment**

Upgrading a garage door is one of the smartest investment your client can make. In fact, according to the Cost vs. Value Report*, replacing a basic garage door with an upgraded one is one of the top ranked renovations in the study. Now, that's a return on investment you can take to the bank.

The Genuine. The Original.



www.overheaddoor.com

*Based on National Association of Realtors members included in Cost vs. Value Study for upscale projects rather than actual sales data. Complete data from the Remodeling 2020 Cost vs. Value report can be downloaded at www.costvsvalue.com.

HAVE THE DOORS YOU'RE INSTALLING BEEN GETTING LIGHTER?

OUR LEGACY™ STEEL DOORS
ARE MADE WITH **49% MORE STEEL.**

When Performance Matters.

provia.com/more-steel



DOORS | WINDOWS
SIDING | STONE | ROOFING

DOES YOUR STONE MANUFACTURER HAVE SOME COMMITMENT PROBLEMS?

ORDER PROVIA'S MANUFACTURED STONE.
IT SHIPS IN DAYS, NOT WEEKS. ALL YEAR.

When Performance Matters.

provia.com/ships-in-days



DOORS | WINDOWS
SIDING | STONE | ROOFING





FLUROPON[®]
COIL COATINGS

RAISE YOUR SIGHTS



Bring more business your way with metal roofing. From authentic traditional looks to fabulous contemporary styles, nothing is attracting high-end homeowners like new metal solutions. That means now is the perfect time to elevate your product offerings and profitability. Discover how seamlessly you can develop the expertise and make the connections you need.

For more information, visit makemorewithmetal.com to learn more about metal roofing.



BUILDING SOLUTIONS

*Products that last, innovation
and expertise you can trust.*



INSPIRATION

Sierra Pacific Windows, The Instagram Page You Need To Follow Today For All Your Home Remodeling Inspirations!

PROJECT TYPE	SEATTLE			PACIFIC			2020 NATIONAL AVERAGES		
	Job Cost	Resale Value	Cost Recouped	Job Cost	Resale Value	Cost Recouped	Job Cost	Resale Value	Cost Recouped
Bathroom Addition Midrange	\$ 59,278	\$ 40,500	68.3%	\$ 58,038	\$ 34,210	58.9%	\$ 49,598	\$ 26,807	54.0%
Bathroom Addition Upscale	106,632	70,334	66.0%	104,722	59,075	56.4%	91,287	49,961	54.7%
Bath Remodel Midrange	25,416	20,183	79.4%	24,757	16,349	66.0%	21,377	13,688	64.0%
Bath Remodel Upscale	77,505	50,241	64.8%	75,763	40,882	54.0%	67,106	37,995	56.6%
Bath Remodel Universal Design	39,711	26,769	67.4%	39,097	25,824	66.1%	34,643	21,463	62.0%
Minor Kitchen Remodel Midrange	26,234	23,382	89.1%	26,150	22,657	86.6%	23,452	18,206	77.6%
Major Kitchen Remodel Midrange	76,145	53,061	69.7%	75,292	47,780	63.5%	68,490	40,127	58.6%
Major Kitchen Remodel Upscale	150,411	100,606	66.9%	148,216	85,009	57.4%	135,547	72,993	53.9%
Master Suite Addition Midrange	161,317	118,148	73.2%	159,510	103,998	65.2%	136,739	80,029	58.5%
Master Suite Addition Upscale	330,135	200,741	60.8%	325,452	178,933	55.0%	282,062	145,486	51.6%
Deck Addition Composite	22,000	19,393	88.1%	22,762	16,065	70.6%	19,856	13,257	66.8%
Deck Addition Wood	18,888	17,964	95.1%	18,059	13,924	77.1%	14,360	10,355	72.1%
Entry Door Replacement Steel	2,068	1,453	70.3%	2,048	1,801	87.9%	1,881	1,294	68.8%
Grand Entrance Fiberglass	10,096	6,394	63.3%	9,955	6,083	61.1%	9,254	4,930	53.3%
Garage Door Replacement	3,882	4,136	106.6%	3,874	4,537	117.1%	3,695	3,491	94.5%
Window Replacement Vinyl	19,501	17,462	89.5%	19,184	14,296	74.5%	17,641	12,761	72.3%
Window Replacement Wood	23,170	19,000	82.0%	22,976	16,750	72.9%	21,495	14,804	68.9%
Siding Replacement Fiber-Cement	20,698	19,646	94.9%	20,064	15,647	78.0%	17,008	13,195	77.6%
Siding Replacement Vinyl	17,479	15,205	87.0%	16,937	12,687	74.9%	14,359	10,731	74.7%
Manufactured Stone Veneer	10,000	11,852	118.5%	10,175	12,157	119.5%	9,357	8,943	95.6%
Roofing Replacement Asphalt Shingles	28,222	22,201	78.7%	27,769	20,902	75.3%	24,700	16,287	65.9%
Roofing Replacement Metal	47,073	32,558	69.2%	46,932	30,674	65.4%	40,318	24,682	61.2%